

kadaster



Historische kadastrale kaart

Eric Hagemans

NCG seminar 14 april 2026

Historische kadastrale kaart en veldwerken

- **bronnen:** hulpkaarten, veldwerken & kadastrale kaart
- digitaliseerslagen van de bronnen
- **Vectoriseren hulpkaarten** -> historische view op bronnen
- 2010 – 1950 -> project in 2010 tbv erfdiensbaarheden onderzoek
- 1950 –begin (1832) -> uitbreiding project in 2021 binnen KKN-programma
- (vector) - **geometrie & index**
- Gebruik:
 - KKN (positionering veldwerken)
 - Erfdiensbaarheden
 - “kadastertijdreis” -> bestaat (nog) niet!

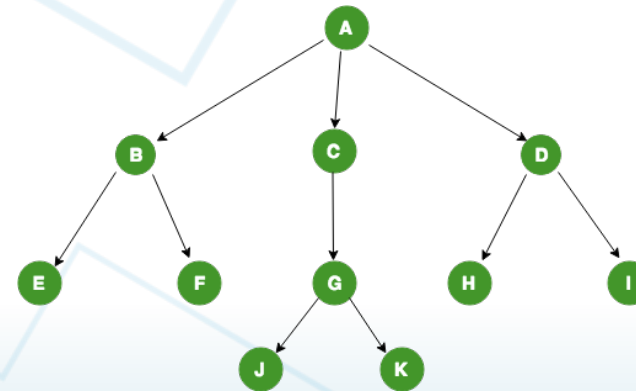



Field document

- Original measurements
- Availability: 90% of boundaries
- Local connections!
- High accuracy

7882

GEMEENTE *Ambt. Hardenberg.*

Dien

Sectie *H.* Blad *3, 4* ^{1^o gede.}, *6* ^{1^o gede.}, *6* ^{2^o gede.}

Nieuwe Nummers:

Niet vernummerd: *1951, 2106, 2023, 2112, 1788*

Opdracht N^o.

Stulpkaart nr. 23
9/2305

Stichting

2106

bes & heide

vw66

Stulpkaart nr. 24.

1951 vw112
vw54
bes & heide

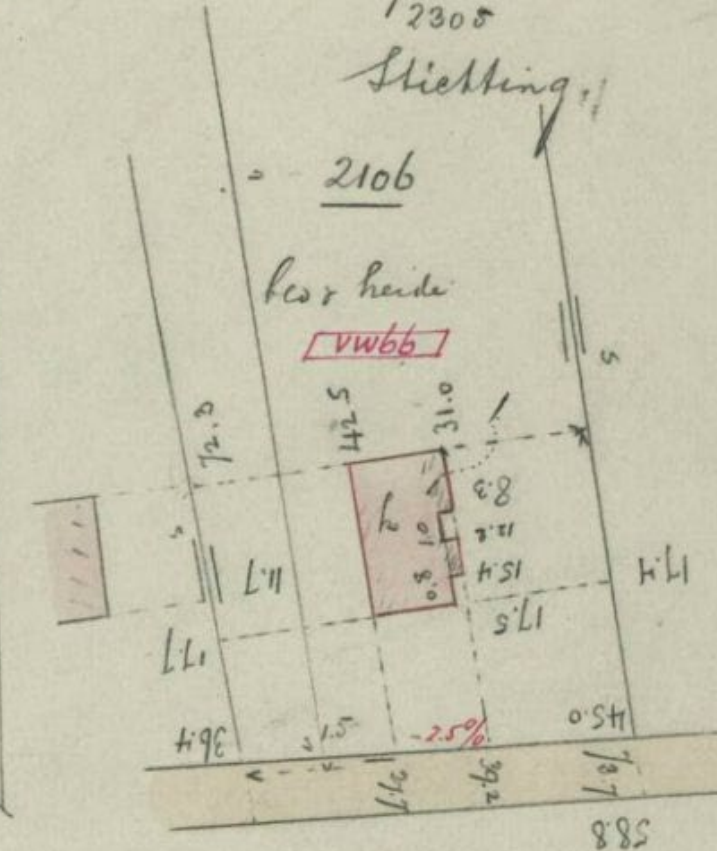
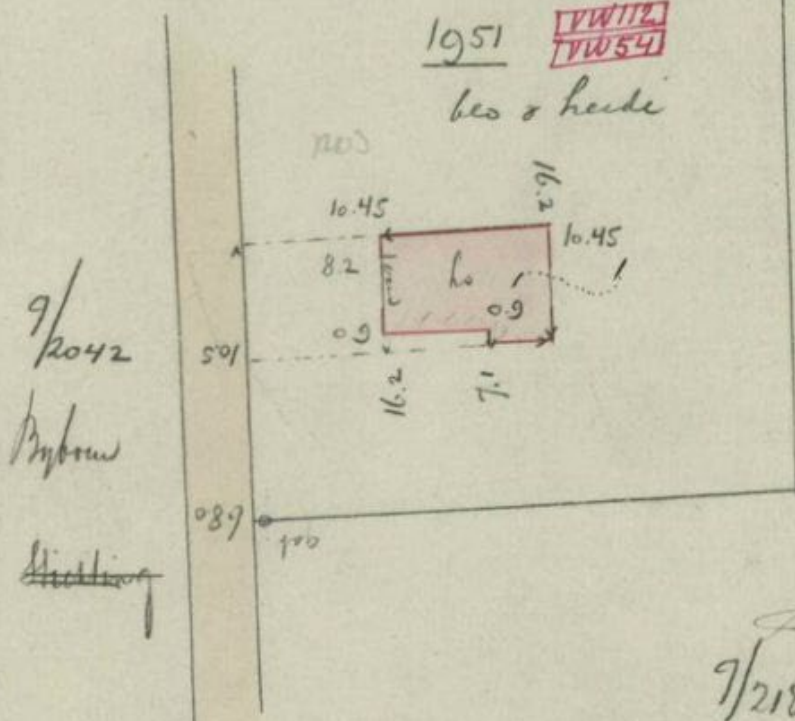

Stulpkaart nr. 26
9/2185, 2189. *Stichting.*



Hulpkaarten “was-wordt”

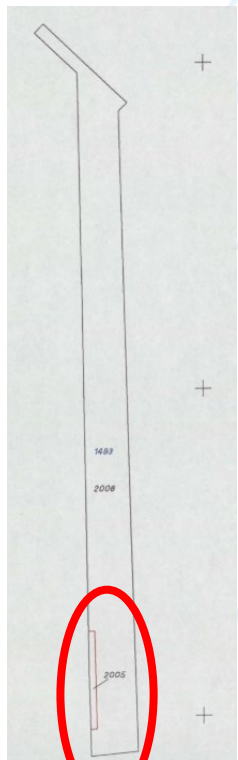

oud: 1493
nieuw: 2005 & 2006

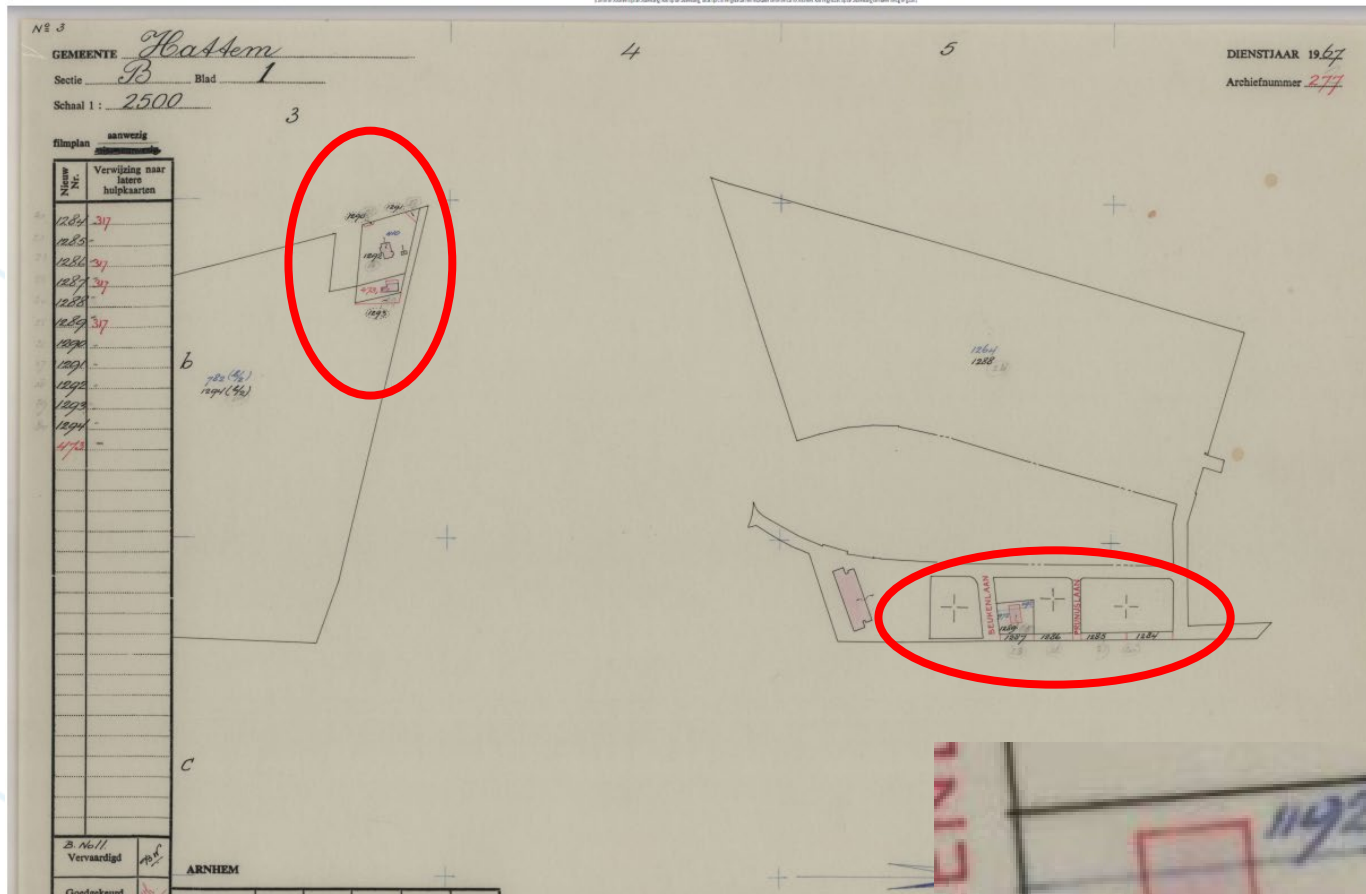

oud: 1192 & 972
nieuw: 1289

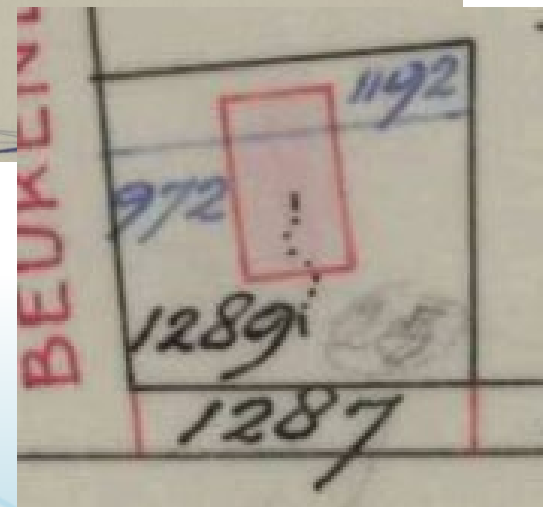



Improvement of the cadastral map

What?

- communication about quality
- improvement geometric quality

Why?

- need to “find your boundary”
- uncertainty about parcelsize

How?

- automatic calculation & mapping
- extended datamodel



KKN productiestraat

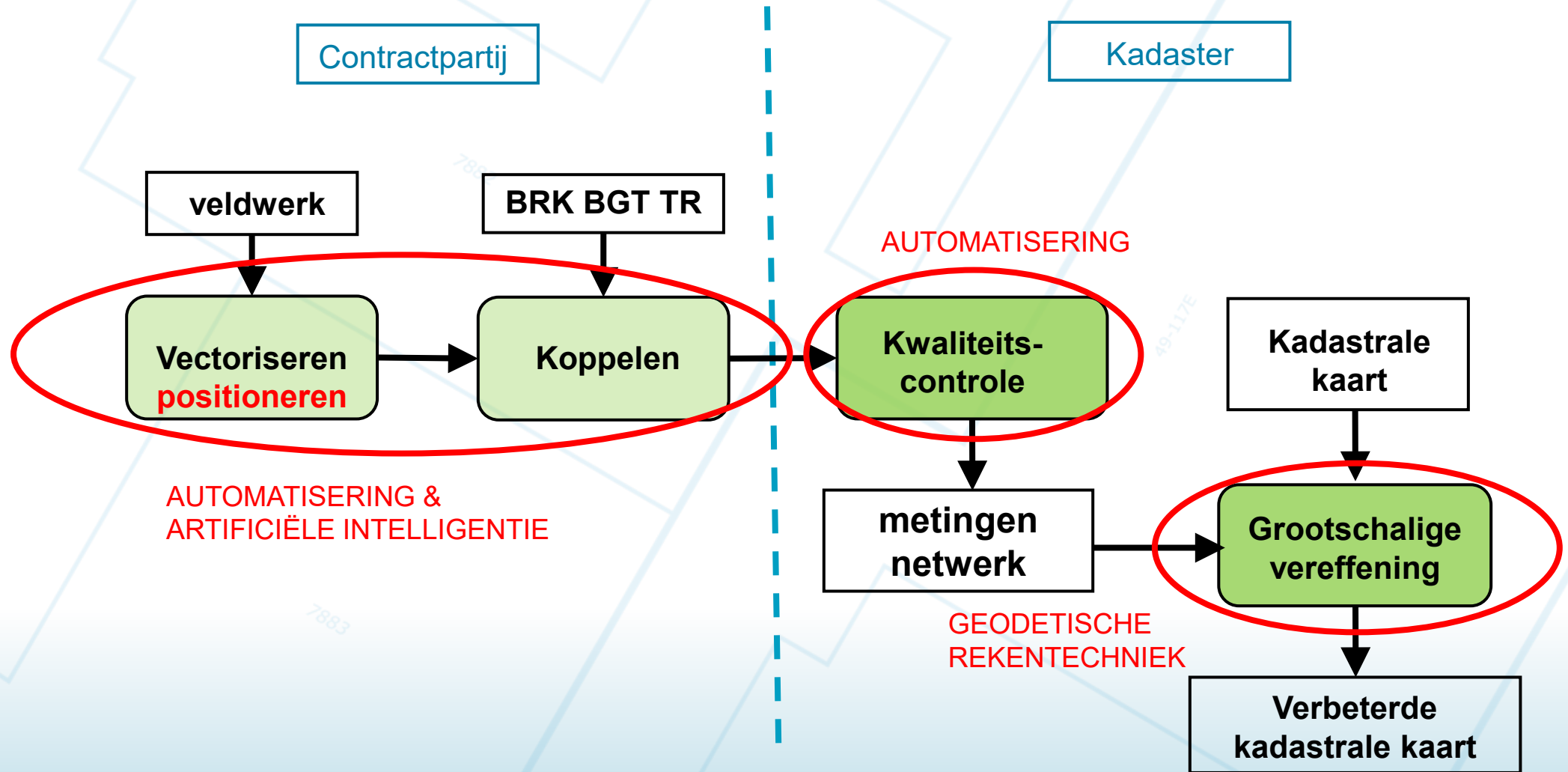

Vectorisatie

localhost:5000/edit/60c522a4/c21d1e0/1d6db0a

dev 0.2.0-#df0d05

Edit Field sketch BER02 L 80

Move3 LSA Adjust Background

Autofocus
Hide elements
Color overlay

Save I'm d

ACTIVE SELECTION

Type: measurement
Color: black
Value: 39.96
Point: p31
Origin: p33
Line: 111 (edit)
4. Line: m11L33
Disabled: no

Flip textbox (f)

Groups

Points: Lines
Text: Symbols
Buildings: Semantic_lines
Tables: Measurement
Lines: Lines

t97 t99 t100 t101
t102 t103 t104 t105
t107 t108 t109 t111
t114 t117 t118 t119
t120 t121 t122 t123
t124 t125 t126 s1
s2 s3 s4 s5
s6 s7 s8 s9
s10 s11 s12 s13
s14 s15 s16 s17

Large Scale Adjustment 1.5

Statistics:

F-test:	2443.78
Number of stations:	76
Number of observations:	389
Degrees of freedom:	237

Rejected tests - Please check!

Type	Record	Station	Target	Value	W-test	Est. err	GW
TD	t97	p33	p31	39.96	725.72	1336.11	0.16
CH	t13	p54	p18 p12	29.82	-530.43	-1357.09	0.22
CH	t94	p16	p18 p12	19.85	609.51	1236.87	0.21
PL	t77	p33	p49 p16	0.00	477.30	730.10	0.15
PL	t82	p31	p48 p54	0.00	-445.28	-698.77	0.15
CH	t122	p38	p36 p39	9.94	-229.79	-431.88	0.16
AN	s15	p31	p32 p34	100.00	229.51	398.96	1.07
PL	t36	p34	p48 p54	0.00	-215.73	-311.81	0.13
PL	t96	p36	p48 p54	0.00	192.80	280.51	0.13
AN	s10	p38	p37 p41	100.00	-190.92	-373.63	1.37

ADVANCED



KKN-proces (in het heeeeel kort): Positioneren

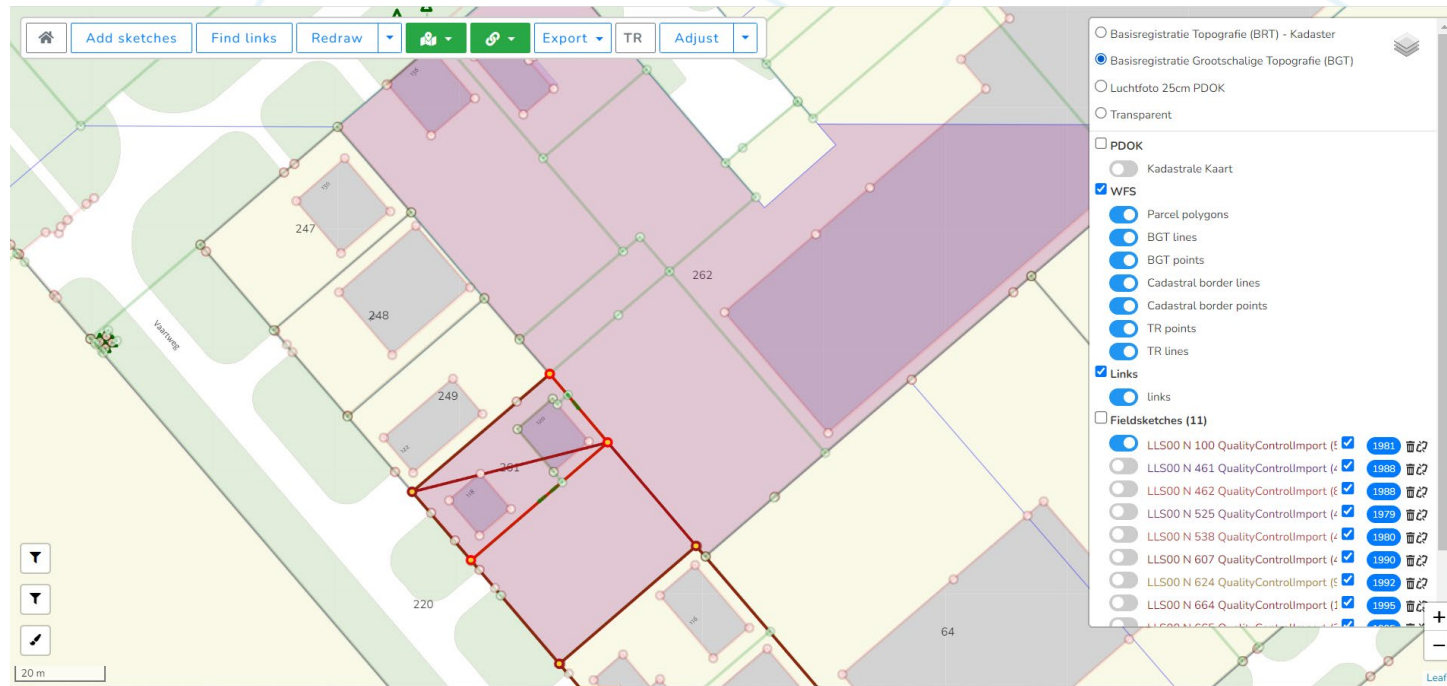

Op basis van de historische perceelnummers en de bijbehorende historische hulpkaart informatie (in paars) kan semi-geautomatiseerd het veldwerk op de juiste plek in Nederland worden geplaatst.

Lukt dit niet automatisch dan geeft de historische kadastrale kaart aan welke percelen gevormd zijn en kan op basis daarvan het veldwerk (met de hand) gepositioneerd worden.

The image displays a web-based interface for the Dutch cadastre (kadaster). The main map area shows a complex network of colored lines and points overlaid on a street map. The lines represent various cadastral features, and the points represent specific locations. The interface includes a toolbar at the top with buttons for 'Add sketches', 'Find links', 'Redraw', 'Export', and 'Adjust'. On the right side, there is a legend panel with several sections: 'Basisregistratie Topografie (BRT) - Kadaster', 'Basisregistratie Grootsschalige Topografie (BGT)', 'Luchtfoto 25cm PDOK', 'Transparent', 'PDOK', 'WFS', 'Links', and 'Fieldsketches (60)'. The 'Fieldsketches' section lists 24 items, each with a colored circle, a text label, and a status icon. At the bottom left, there is a scale bar showing 30 meters and a 'Leaflet' logo.

Toolbar: Add sketches, Find links, Redraw, Export, Adjust

Legend:

- Basisregistratie Topografie (BRT) - Kadaster
- Basisregistratie Grootsschalige Topografie (BGT)
- Luchtfoto 25cm PDOK
- Transparent
- PDOK
 - Kadastrale Kaart
 - WFS
 - Hulpkaart polygons
 - Hulpkaart points
 - Gebouwen lines
 - Gebouwen points
 - Cadastral border lines
 - Cadastral border points
 - RD points
 - Links
 - links
 - Fieldsketches (60)
 - BER02 L 98 edit-4 (2498)
 - BER02 L 99 edit-5 (2499)
 - BER02 L 100 edit-3 (2500)
 - BER02 L 101 edit-3 (2501)
 - BER02 L 101 edit-3 (2502)
 - BER02 L 102 edit-5 (2503)
 - BER02 L 103 edit (2504)
 - BER02 L 104 edit-3 (2505)
 - BER02 L 110 edit-4 (2506)
 - BER02 L 112 edit-2 (2509)
 - BER02 L 113 edit-3 (2510)
 - BER02 L 114 edit-3 (2511)
 - BER02 L 115 edit-3 (2512)
 - BER02 L 116 edit-3 (2513)
 - BER02 L 117 edit-2 (2514)
 - BER02 L 118 edit-3 (2515)
 - BER02 L 119 edit-4 (2516)
 - BER02 L 120 edit-3 (2517)
 - BER02 L 121 edit-3 (2518)
 - BER02 L 121 edit-3 (2519)
 - BER02 L 122 edit-2 (2520)
 - BER02 L 123 edit-2 (2521)
 - BER02 L 124 edit-5 (2522)
 - BER02 L 124 edit-5 (2523)

Map labels: Meester Vermoulenstraat, Didams, Den Hamweg, Berkenl...

Scale: 30 m

Leaflet

Kadaster historie model

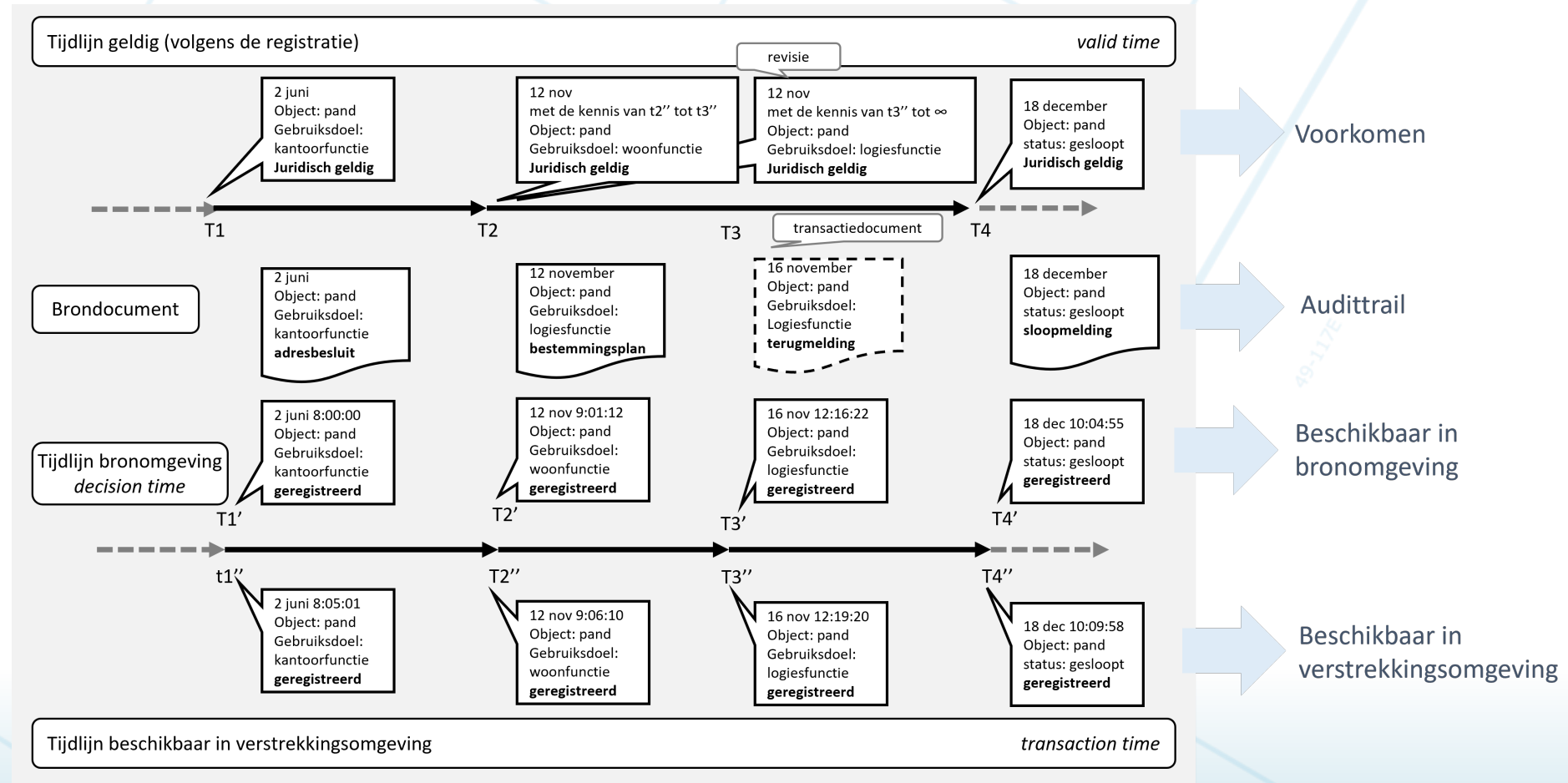

Data modelling (LADM-inspired)

Registration terrestique (TR)

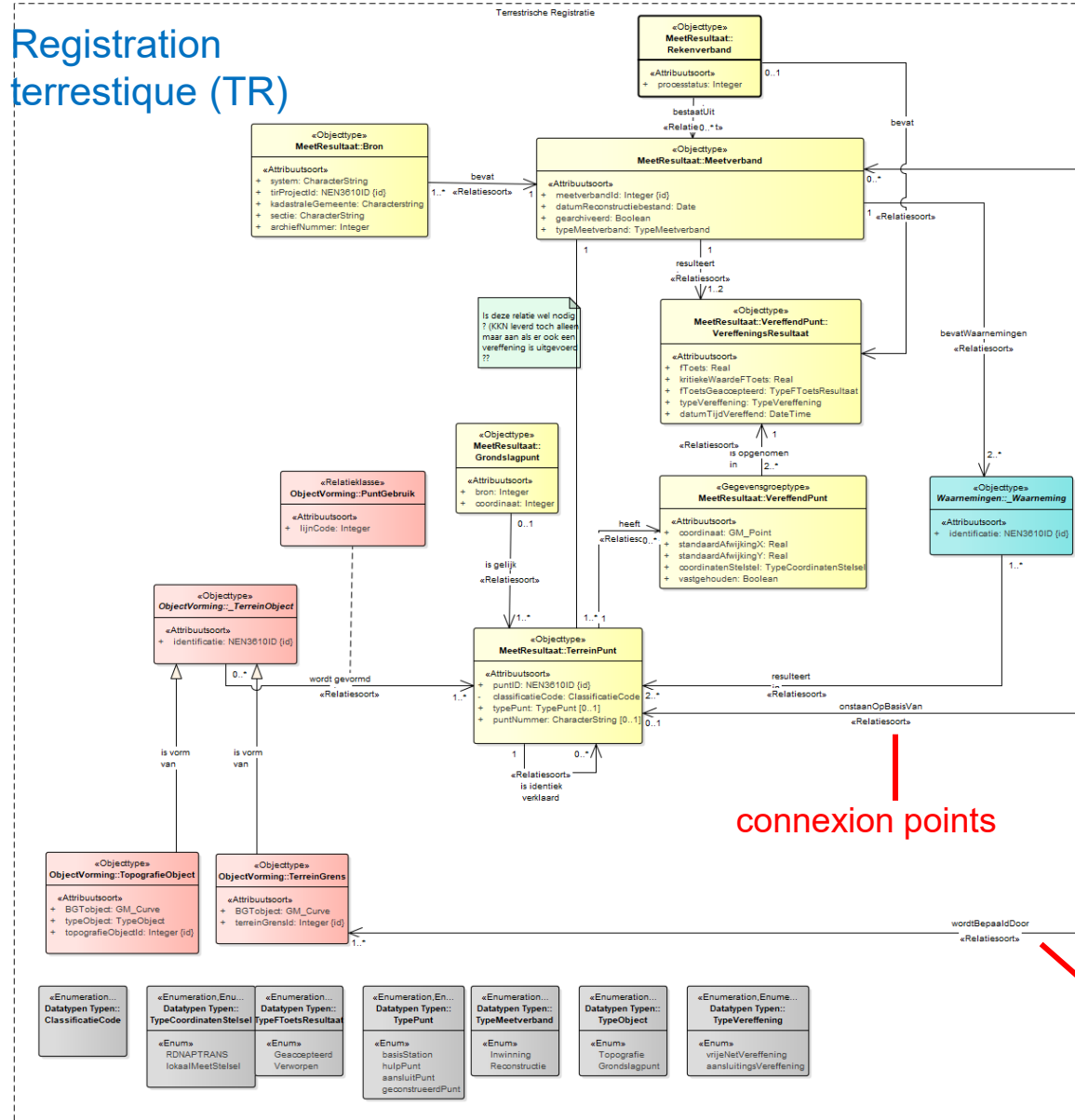

connexion points

Archive des croquis

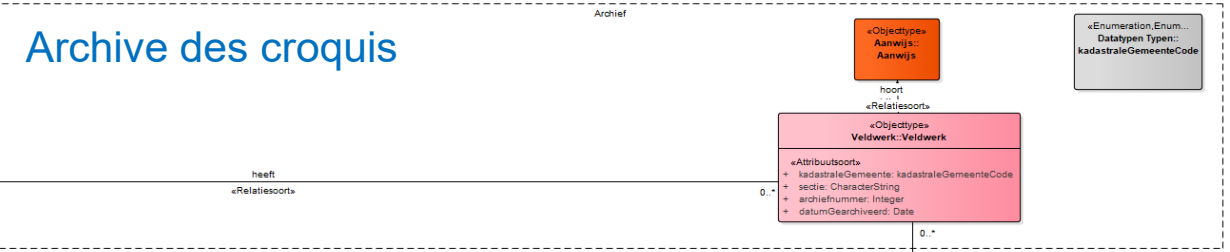

Plan Cadastral (BRK-geo)

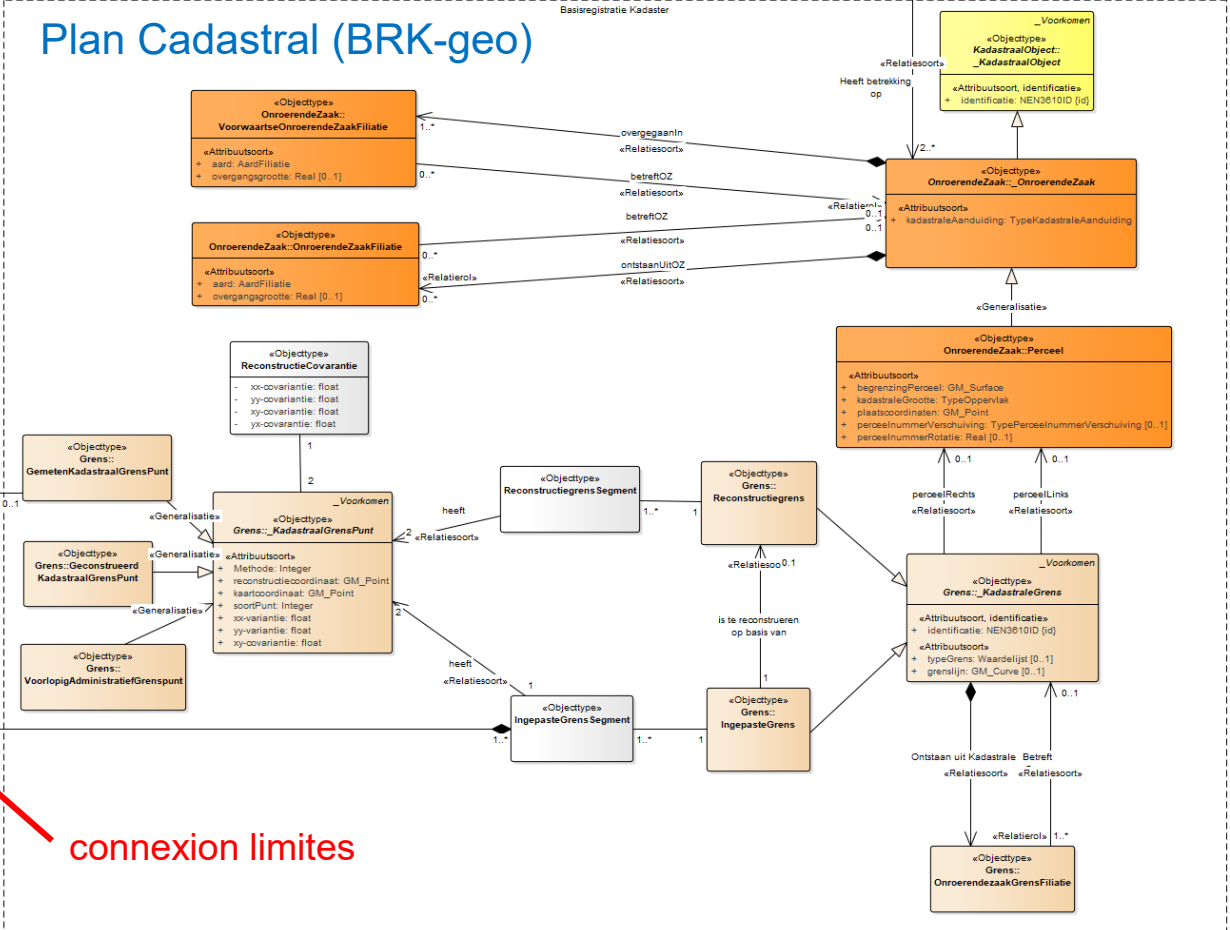

connexion limites